



MOTORCYCLE DOCTOR LLC

Craig Silvers,
Owner

PO Box 1676 / 108 N. Business Rt. 5 Camdenton, Mo 65020
(573) 346-6867

web site: www.MotorcycleDoctor.com

email: Craig@MotorcycleDoctor.com

Cam Timing HiSun 450, 500, 550

1. Rotate Crank to TDC. (turn crank end Bolt or Fan counter clockwise) Make sure Cam Chain is Inline with the lower crank sprocket.

Look for the 'I' mark on the Flywheel in the Inspection Window, not the long 'H'. (Do not turn crankshaft during camshaft installation)

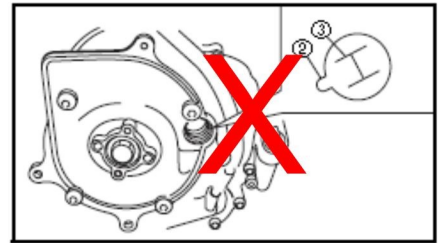
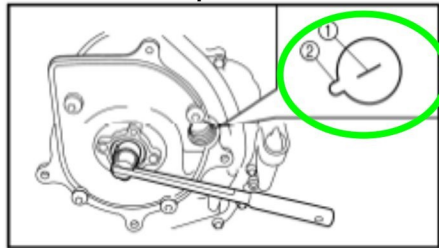

2. Install Cam with Cam Lobes facing down at 5 & 7 O'Clock (cam will rotate left and right about 1/2 turn each way)

3. Move bolt holes to 6 & 12 O'Clock. Make sure Cam Location Dot is on top. ●

Decompression dot ○

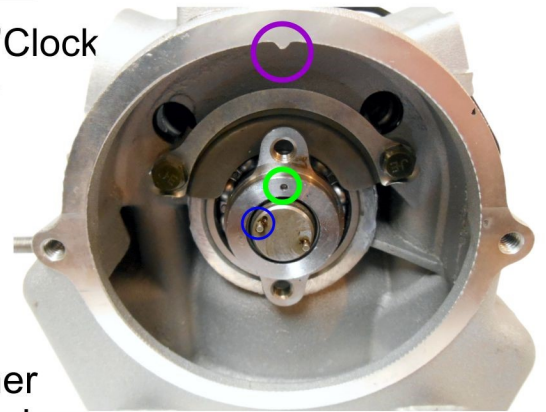

4. Make sure tensioner is removed from cylinder.

Line up the cam Sprocket Dot with Cam Dot. Lower the sprocket down enough to wrap timing chain over the top of sprocket. Lift sprocket back to cam add Loc-Tite to the mounting bolts and lightly tighten. Check flywheel TDC mark and cam sprocket dot with head notch. ○

5. Install Tensioner and new gasket to cylinder by resetting ratchet shaft, removing tower hollow bolt and spring, release ratchet lock and push shaft in. Install tensioner, 2 bolts, spring and hollow bolt. This will put tension on the cam timing chain. Finish tightening 2 Sprocket bolts with 2 sheet metal cover plates.

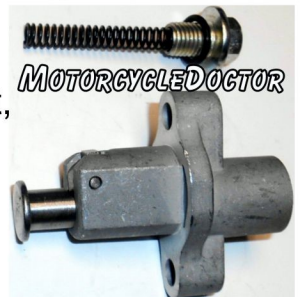

6. Rotate the Crankshaft (2) full turns which brings the cam and sprocket back to it's original position. Double check the TDC and sprocket marks.

7. Now Adjust Valves when Cam Lobes are down. Intake .005", Exhaust .007"